



FITTING INSTRUCTIONS FOR LP0349



THIS KIT CONTAINS THE ITEMS PICTURED AND LABELLED OVER PAGE.

SOME PARTS MAY BE SHOWN FOR CLARITY OF INSTRUCTIONS ONLY.

DO NOT PROCEED UNTIL YOU ARE SURE ALL PARTS ARE PRESENT.

PLEASE READ ALL INSTRUCTIONS BEFORE PROCEEDING.

**IF IN ANY DOUBT WHEN FITTING OUR PRODUCTS, CONSULT ONE OF OUR DEALERS
OR HAVE FITTED BY A QUALIFIED TECHNICIAN.**

PLEASE NOTE THAT THE WAY THE KIT IS PACKED DOES NOT NECESSARILY REPRESENT THE WAY OF
MOUNTING TO THE BIKE.

IN THE EVENT OF RUBBER WASHERS BEING USED TO HOLD COMPONENTS ONTO BOLTS,
THESE RUBBER WASHERS CAN BE THROWN AWAY.

R&G

Unit 1, Shelley's Lane, East Worldham, Alton, Hampshire, GU34 3AQ
Tel: +44 (0)1420 89007 Fax: +44 (0)1420 87301 www.rg-racing.com Email: info@rg-racing.com



DIGITAL COPIES OF THESE INSTRUCTIONS ARE AVAILABLE FROM:

WWW.RG-RACING.COM

<u>TOOLS REQUIRED</u>	<u>GENERAL TORQUE SETTINGS</u>
Set of metric Allen keys to include 4 & 5mm A/F size	M4 BOLT = 8Nm
10mm spanners or socket and wrench	M5 BOLT = 12Nm
14mm spanner	M6 BOLT = 15Nm
Phillips screwdriver	M8 BOLT = 20Nm
Cable cutters	M10 BOLT = 40Nm
Small amount of adhesive	M12 BOLT = 40Nm

LEGEND

ITEM NO.	DESCRIPTION	QTY
ITEM 1	SPACERS (S1025=8.5mm LONG)	4
ITEM 2	COVER PLATE (TB0225 PART 2)	1
ITEM 3	LICENCE PLATE BRACKET (TB0349)	1
ITEM 4	SMALL RUBBER GROMMETS (RB50-20-00FG)	2
ITEM 5	LA0002 LICENCE PLATE ILLUMINATOR	1
ITEM 6	LICENCE PLATE ILLUMINATOR SHROUD	1
ITEM 7	LARGE RUBBER GROMMET (RB0002)	1
ITEM 8	M6 WASHERS	4
ITEM 9	M6 x 28mm LONG BUTTON HEAD BOLTS	4
ITEM 10	LICENCE PLATE ILLUMINATOR CONNECTORS	1
ITEM 11	150mm LENGTH OF HEATSHRINK	1
ITEM 12	2.5mm CABLE TIES	3
ITEM 13	SELF-ADHESIVE CABLE CLIPS	3
ITEM 14	REFLECTOR	1

R&G

Unit 1, Shelley's Lane, East Worldham, Alton, Hampshire, GU34 3AQ

Tel: +44 (0)1420 89007 Fax: +44 (0)1420 87301 www.rg-racing.com Email: info@rg-racing.com

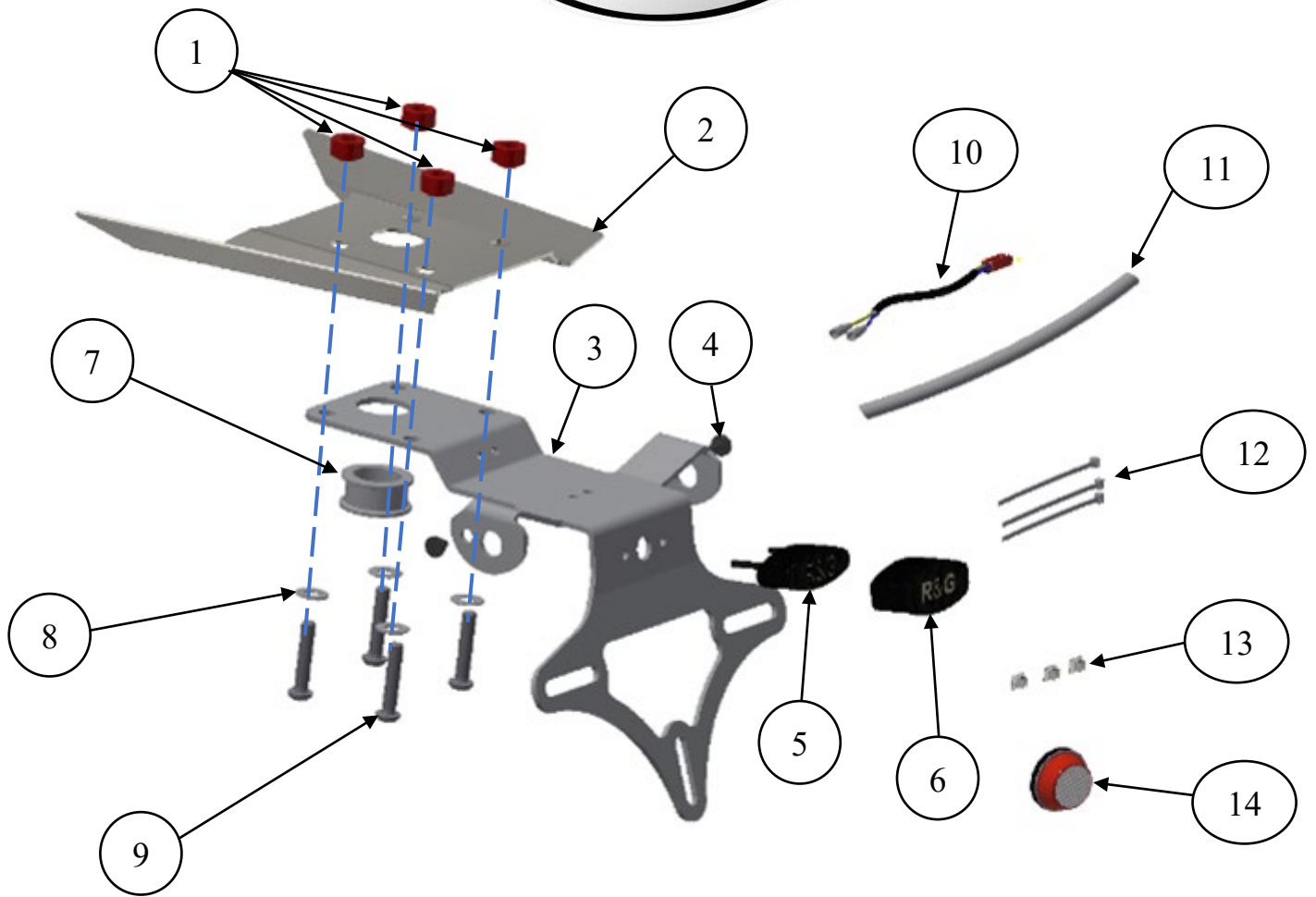

Assembly Diagram 1



PICTURE 1

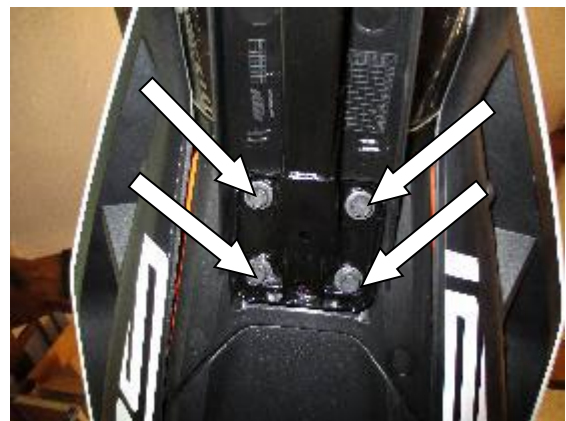

PICTURE 2

R&G

Unit 1, Shelley's Lane, East Worldham, Alton, Hampshire, GU34 3AQ

Tel: +44 (0)1420 89007 Fax: +44 (0)1420 87301 www.rg-racing.com Email: info@rg-racing.com

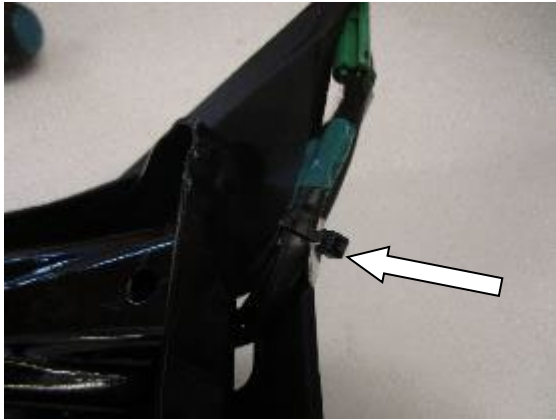

PICTURE 3

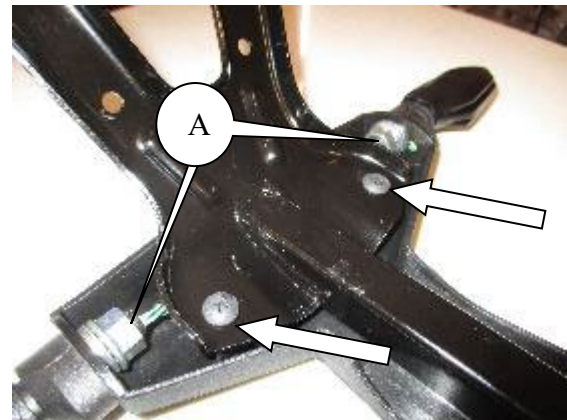

PICTURE 4

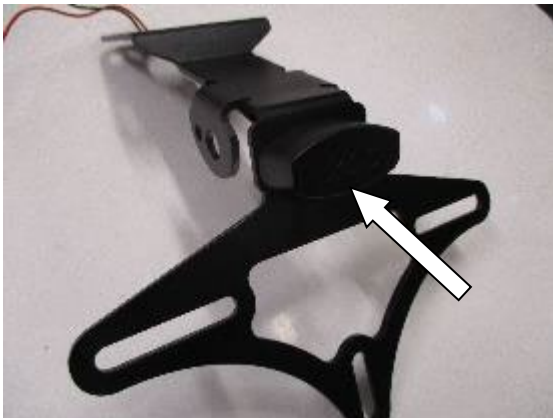

PICTURE 5



PICTURE 6



PICTURE 7



PICTURE 8

R&G

Unit 1, Shelley's Lane, East Worldham, Alton, Hampshire, GU34 3AQ

Tel: +44 (0)1420 89007 Fax: +44 (0)1420 87301 www.rg-racing.com Email: info@rg-racing.com



PICTURE 9



PICTURE 10

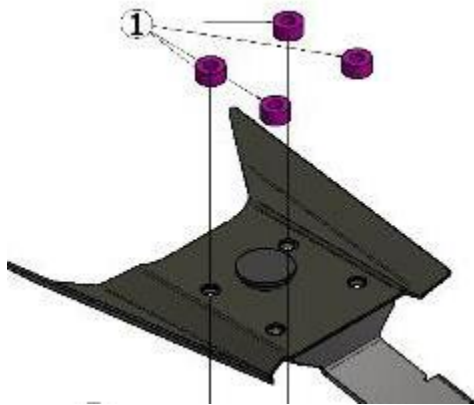

PICTURE 11

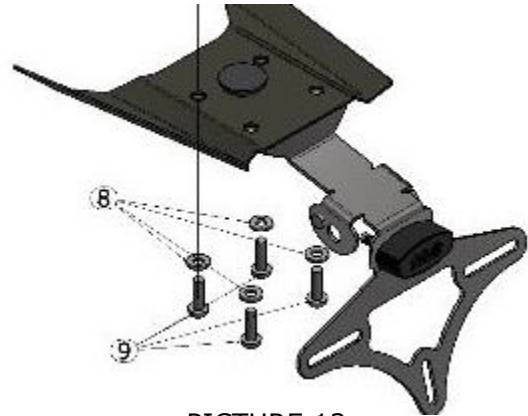

PICTURE 12

FITTING INSTRUCTIONS

- To fit R&G tail tidy, remove the seat using the key and disconnect the licence plate illuminator and indicator connectors in the positions that are arrowed in **Picture 1**.
- Remove the four bolts that mount the OEM licence plate bracket to the underside of the subframe, as shown in **Picture 2** and gently remove from the bike, feeding the wiring out in the process.
- On the OEM licence plate bracket, cut the cable tie that ties all the wires together as shown in **Picture 3**.
- Remove the two screws arrowed in **Picture 4** using a Philips screwdriver. The OEM licence plate bracket can now be separated.
- Remove the two indicators by removing the nuts and washers labelled A in **Picture 4** using 14mm open ended spanner. The OEM indicator washers and nuts are to be re-used.
- From the kit, take the R&G licence plate bracket (**Item 3**) and fit R&G licence plate illuminator (**Item 5**) into the three in-line holes on the licence plate bracket and secure with the M3 washers & nuts provided (Arrowed in **Picture 5**). Apply a small amount of super glue around the top surface of the license plate illuminator (**Item 5**) and place the licence plate illuminator shroud (**Item 6**) over.
- Feed the licence plate illuminator wires through one of the heat-shrink tube (**Item 11**) provided and using a suitable heat resource, shrink the tube to protect the wires.

R&G

Unit 1, Shelley's Lane, East Worldham, Alton, Hampshire, GU34 3AQ

Tel: +44 (0)1420 89007 Fax: +44 (0)1420 87301 www.rg-racing.com Email: info@rg-racing.com



- If using OEM indicators, fit both indicators onto indicator mount on the licence plate bracket as shown in **Picture 6** and secure using OEM washer and nuts removed earlier.
- From the kit, take the three cable clips (**Item 13**) and attach them in-line onto the underside of the licence plate bracket as shown in **Picture 7**.
- From the kit take the cover plate (**Item 2**) and Rubber bung (**Item 7**), Place the Licence plate bracket (**Item 3**) assembly onto the cover plate (**Item 2**), align all the mounting holes as shown in **Picture 8**. Insert the Rubber bung (**Item 7**) through the large centre holes on both licence plate bracket and the cover plate. The rubber bung will hold the two plates together.
- Feed all the wires through the Rubber bung (**Item 7**) fitted earlier (as shown in **Picture 9**) and clip-in all the wires to the cable clips (**Item 13**) fitted earlier on the underside of the licence plate bracket as shown in **Picture 10**.
- From the kit take the four spacers (**Item 1**) provided. Place the spacers on top of the four mounting points on the licence plate bracket assembly with the counter-bore sits against the cover plate as shown in **Picture 11**.
- Offer the whole assembly towards the sub-frame of the motorcycle and secure using the four button head bolts (**Item 9**) and washers (**Item 8**) as shown in **Picture 12**. Tighten the bolts to an appropriate torque setting.
- Please ensure the assembly accuracy of the fitted components are the same as the diagram shown on **Page 1**.
- Connect the licence plate & indicator connectors to the main loom as original.
- Tidy all the wiring using cable ties provided.
- Check all the lights for correct operations.
- Fit a licence plate to new licence plate bracket (it may require re-drilling).
- **IMPORTANT: WHEN FITTING A LICENCE PLATE, IT MUST BE PLACED AS HIGH AS POSSIBLE ON THE LICENCE PLATE HANGER AND CHECKED FOR COLLISION WITH THE REAR WHEEL WHEN THE SUSPENSION IS AT FULL COMPRESSION, THERE IS A SMALL CHANCE OF THE LICENCE PLATE HITTING THE BACK WHEEL UNDER HEAVY LOAD AND OVER LARGE BUMPS IN THE ROAD. IT IS YOUR RESPONSIBILITY TO CHECK FOR THIS POSSIBILITY AND TAKE AVOIDING ACTION. FAILURE TO CHECK THIS COULD RESULT IN SERIOUS INJURY.**
- Refit the seat.
- Depending on local laws, attach enclosed red reflector (**Item 14**) in an appropriate location.
- **Please test the rear light and licence plate illuminator before riding.**

See more R&G products for your Motorcycle in the link below:

[R&G Racing | All Products for KTM - 200 Duke \(rg-racing.com\)](http://www.rg-racing.com)

ISSUE 1 26/10/2022 (MH)

CONSUMER NOTICE

The catalogue description and any exhibition of samples are only broad indications of the Products and R&G may make design changes which do not diminish their performance or visual appeal and supplying them in such state shall conform to the order. The Buyer acknowledges no representation or warranty (other than as to title) has been given or will apply to the Products other than those in R&G's order or confirmation and the Buyer confirms it has chosen the Products as being of merchantable quality and suitable for its particular purposes. Where R&G fits the Products or undertakes other services it shall exercise reasonable skill and care and rectify any fault free of charge unless the workmanship has been disturbed. The Buyer is responsible for ensuring that the warranty on the motorcycle is not affected by the fitting of the Products. On return of any defective Products R&G shall at its option either supply a replacement or refund the purchase money but shall not be liable if the Products have been modified or used or maintained otherwise than in accordance with R&G's or manufacturer's instructions and good engineering practice or if the defect arises from accident or neglect. Other than identified above and subject to R&G not limiting its liability for causing death

R&G

Unit 1, Shelley's Lane, East Worldham, Alton, Hampshire, GU34 3AQ

Tel: +44 (0)1420 89007 Fax: +44 (0)1420 87301 www.rg-racing.com Email: info@rg-racing.com



and personal injury, it shall not be liable for indirect or consequential loss and otherwise its liability shall be limited to the amounts paid by the Buyer for the Products or the fitting or service concerned. These terms do not affect the Buyer's statutory rights.

R&G RETURNS POLICY (NON-FAULTY GOODS)

Returns must be pre-authorized (if not pre-authorized the return will be rejected). Goods may only be returned direct to us if they were purchased direct from us (customer must prove if necessary). Otherwise to be returned to original vendor. Goods must be in re-sellable condition, in the opinion of R&G. All returns are subject to a 25% restocking and handling fee (25% of the gross value exc. P&P – at the prevailing price at time of purchase). The customer must pay any and all carriage charges. No returns of discontinued products, unless within 14 days of purchase. This policy does not affect your statutory rights and does not refer to faulty goods.

R&G

Unit 1, Shelley's Lane, East Worldham, Alton, Hampshire, GU34 3AQ

Tel: +44 (0)1420 89007 Fax: +44 (0)1420 87301 www.rg-racing.com Email: info@rg-racing.com



NOTICE DE MONTAGE POUR LP0349



CE KIT CONTIENT LES ARTICLES ILLUSTRÉS ET ÉTIQUETES SUR LA PAGE.

CERTAINES PARTIES PEUVENT ÊTRE PRÉSENTES UNIQUEMENT POUR LA CLARTÉ DES INSTRUCTIONS.

NE PAS PROCÉDER AU MONTAGE TANT QUE VOUS N'ÊTES PAS SÛR QUE TOUTES LES PIÈCES SOIENT PRÉSENTES.

VEUILLEZ LIRE TOUTES LES INSTRUCTIONS AVANT DE CONTINUER.

EN CAS DE DOUTE LORS DU MONTAGE DE NOS PRODUITS, CONSULTEZ UN DE NOS REVENDEURS OU FAITES APPEL À UN TECHNICIEN QUALIFIÉ.

VEUILLEZ NOTER QUE LA FAÇON DONT LE KIT EST EMBALLÉ NE REPRÉSENTE PAS NECESSAIREMENT LA MANIÈRE DE LE MONTER SUR LA MOTO.

SI DES RONDELLES EN CAOUTCHOUC SONT UTILISÉES POUR MAINTENIR LES COMPOSANTS SUR LES BOULONS, ELLES PEUVENT ÊTRE JETÉES.

NOTICE DISPONIBLE AU TÉLÉCHARGEMENT SUR : WWW.RG-RACING.COM

R&G

Unit 1, Shelley's Lane, East Worldham, Alton, Hampshire, GU34 3AQ

Tel: +44 (0)1420 89007 Fax: +44 (0)1420 87301 www.rg-racing.com Email: info@rg-racing.com



<u>OUTILS REQUIS</u>	<u>VALEURS DE SERRAGE</u>
Clés Allen 4 & 5mm	M4 BOULON = 8Nm
Clé à molette 10mm	M5 BOULON = 12Nm
Clé à cliquet 14mm spanner	M6 BOULON = 15Nm
Tournevis cruciforme	M8 BOULON = 20Nm
Pince coupante	M10 BOULON = 40Nm
Un peu d'adhésif	M12 BOULON = 40Nm

LÉGENDE

ARTICLE NO.	DESCRIPTION	QTÉ
ARTICLE 1	ENTRETOISES (S1025=8.5mm DE LONG)	4
ARTICLE 2	PROTECTION (TB0225 PARTIE 2)	1
ARTICLE 3	SUPPORT DE PLAQUE (TB0349)	1
ARTICLE 4	OEILLETS EN CAOUTCHOUC (RB50-20-00FG)	2
ARTICLE 5	LA0002 FEU DE PLAQUE	1
ARTICLE 6	FEU DE PLAQUE SHROUD	1
ARTICLE 7	OEILLET EN CAOUTCHOUC LARGE (RB0002)	1
ARTICLE 8	M6 RONDELLES	4
ARTICLE 9	M6 x 28mm BOULONS	4
ARTICLE 10	CONNECTEURS DE FEU DE PLAQUE	1
ARTICLE 11	150mm MANCHON THERMO RÉTRACTABLE	1
ARTICLE 12	2.5mm COLLIERS DE SERRAGE	3
ARTICLE 13	CLIPS AUTOCOLLANTS	3
ARTICLE 14	RÉFLECTEUR	1

R&G

Unit 1, Shelley's Lane, East Worldham, Alton, Hampshire, GU34 3AQ

Tel: +44 (0)1420 89007 Fax: +44 (0)1420 87301 www.rg-racing.com Email: info@rg-racing.com



Schéma d'assemblage 1



PHOTO 1

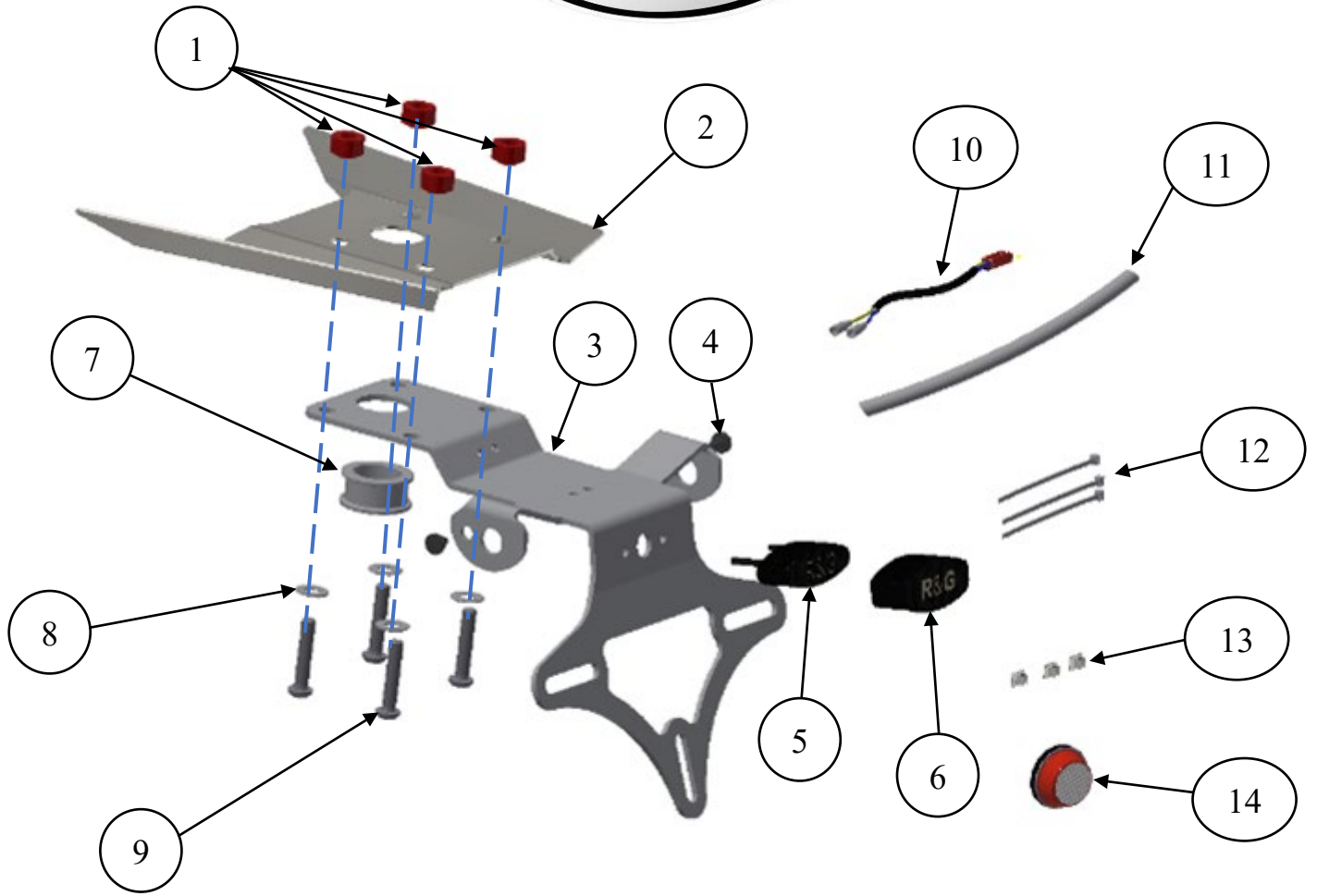
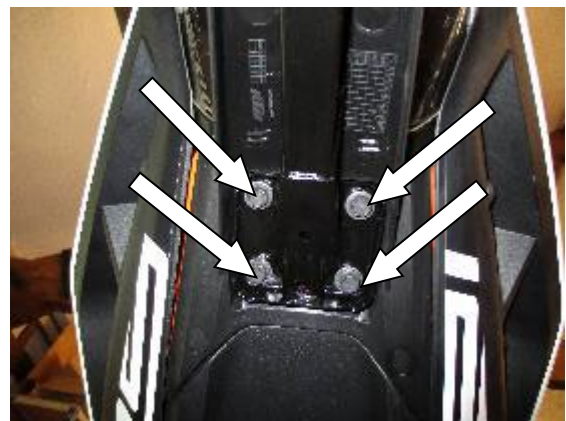

PHOTO 2

R&G

Unit 1, Shelley's Lane, East Worldham, Alton, Hampshire, GU34 3AQ

Tel: +44 (0)1420 89007 Fax: +44 (0)1420 87301 www.rg-racing.com Email: info@rg-racing.com

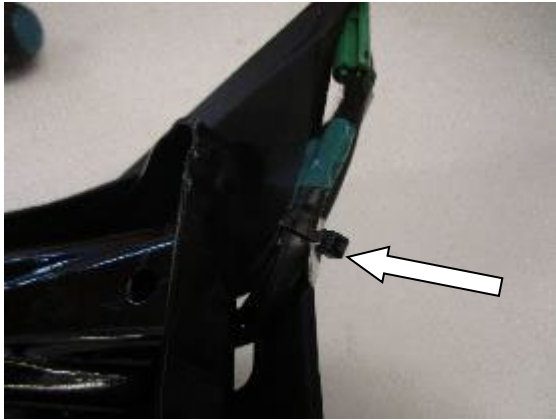

PHOTO 3

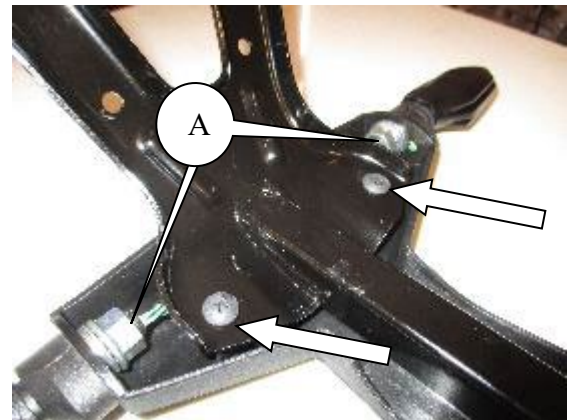

PHOTO 4

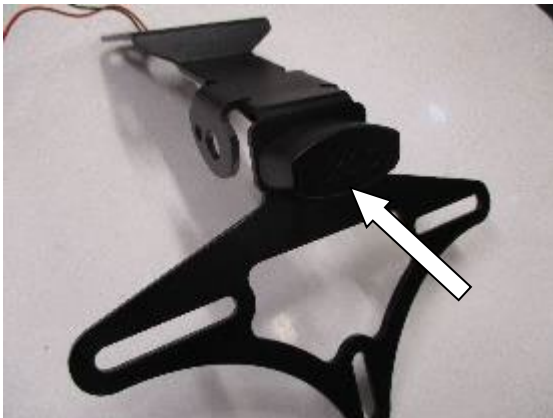

PHOTO 5



PHOTO 6



PHOTO 7



PHOTO 8



PHOTO 9



PHOTO 10

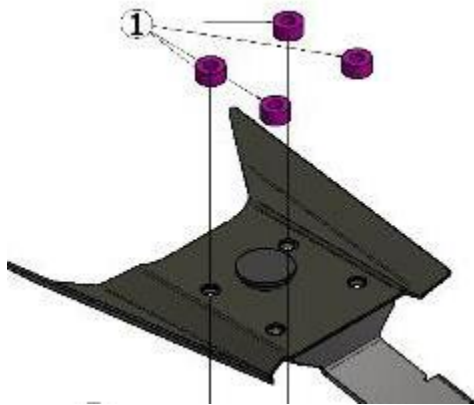

PHOTO 11

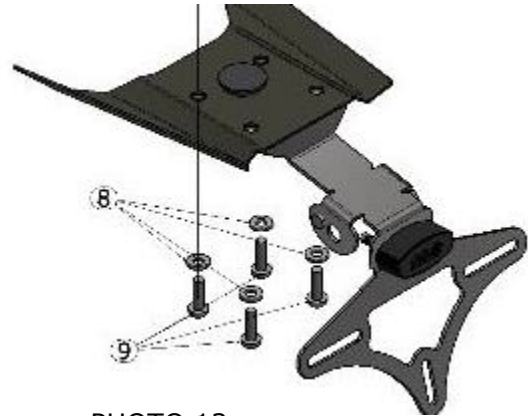

PHOTO 12

NOTICE DE MONTAGE

- Pour installer le support arrière R&G, retirez le siège à l'aide de la clé et débranchez les connecteurs du feu de plaque d'immatriculation et des clignotants dans les positions fléchées sur la photo 1.
- Retirez les quatre boulons qui fixent le support de plaque d'immatriculation d'origine au-dessous du châssis, comme indiqué sur la photo 2 et retirez-les délicatement de la moto, en faisant sortir le câblage dans le processus.
- Sur le support de plaque d'immatriculation d'origine, coupez le serre-câble qui relie tous les fils ensemble comme indiqué sur la photo 3.
- Retirez les deux vis fléchées sur la photo 4 à l'aide d'un tournevis cruciforme. Le support de plaque d'immatriculation d'origine peut maintenant être séparé.
- Retirez les deux clignotants en retirant les écrous et les rondelles étiquetés A sur la photo 4 à l'aide d'une clé à fourche de 14 mm. Les rondelles et écrous de clignotants d'origine doivent être réutilisés.
- Dans le kit, prenez le support de plaque d'immatriculation R&G (article 3) et installez le feu de plaque d'immatriculation R&G (article 5) dans les trois trous alignés sur le support de plaque d'immatriculation et fixez avec les rondelles et écrous M3 fournis (flèches sur la photo 5). Appliquez une petite quantité de super glue autour de la surface supérieure du feu de plaque

R&G

Unit 1, Shelley's Lane, East Worldham, Alton, Hampshire, GU34 3AQ

Tel: +44 (0)1420 89007 Fax: +44 (0)1420 87301 www.rg-racing.com Email: info@rg-racing.com



d'immatriculation (article 5) et placez la protection de feu de plaque d'immatriculation (article 6) dessus.

- Faire passer les fils de feu de plaque dans l'une des gaines thermo rétractables (Article 11) fournies et à l'aide d'un moyen thermique adapté, rétracter la gaine pour protéger les fils.
- Si vous utilisez des clignotants d'origine, installez les deux clignotants sur le support de clignotant sur le support de la plaque d'immatriculation comme indiqué sur la photo 6 et fixez-les à l'aide de la rondelle et des écrous d'origine retirés précédemment.
- Dans le kit, prenez les trois serre-câbles (article 13) et fixez-les en ligne au dessous du support de plaque d'immatriculation comme indiqué sur la photo 7.
- Dans le kit, prenez la plaque de couverture (article 2) et le bouchon en caoutchouc (article 7), placez l'ensemble support de plaque d'immatriculation (article 3) sur la plaque de protection (article 2), alignez tous les trous de montage comme indiqué sur la photo 8. Insérez le bouchon en caoutchouc (article 7) dans les grands trous centraux du support de plaque d'immatriculation et de la plaque de protection. Le bouchon en caoutchouc maintiendra les deux plaques ensemble.
- Faites passer tous les fils à travers le bouchon en caoutchouc (article 7) installé plus tôt (comme indiqué sur la photo 9) et clipsez tous les fils sur les serre-câbles (article 13) installés plus tôt sur le dessous du support de plaque d'immatriculation, comme indiqué sur Photo 10.
- Sortir du kit les quatre entretoises (Article 1) fournies. Placez les entretoises au-dessus des quatre points de montage sur l'ensemble du support de plaque d'immatriculation avec le contre-alésage contre la plaque de protection, comme indiqué sur la photo 11.
- Présentez l'ensemble sur le sous-châssis de la moto et fixez-le à l'aide des quatre boulons à tête ronde (article 9) et des rondelles (article 8) comme indiqué sur la photo 12. Serrez les boulons au couple de serrage approprié.
- Veuillez-vous assurer que la précision d'assemblage des composants montés soit la même que sur le schéma illustré à la page 1.
- Connectez les connecteurs de la plaque d'immatriculation et des clignotants au faisceau principal comme d'origine.
- Rangez tout le câblage à l'aide des serre-câbles fournis.
- Vérifiez que tous les voyants fonctionnent correctement.
- Installez la plaque d'immatriculation sur le nouveau support de plaque d'immatriculation (cela peut nécessiter un nouveau perçage).
- **IMPORTANT : SI VOUS MONTEZ UNE PLAQUE D'IMMATRICULATION DE GRANDE TAILLE ET LA PLACEZ BIEN EN BAS SUR LE SUPPORT DE PLAQUE D'IMMATRICULATION, IL Y A UN RISQUE QUE LA PLAQUE D'IMMATRICULATION FRAPPE LA ROUE ARRIÈRE SOUS UNE CHARGE LOURDE ET SUR DE GROSSES BOSSES SUR LA ROUTE. IL EST DE VOTRE RESPONSABILITÉ DE VÉRIFIER CETTE POSSIBILITÉ ET DE PRENDRE DES MESURES POUR ÉVITER. NE PAS VÉRIFIER CELA POURRAIT ENTRAÎNER DES BLESSURES GRAVES.**
- Remonter le siège.
- En fonction des lois locales, fixez le réflecteur fourni (article 14) à un endroit approprié.
- **Testez le fonctionnement de tous les feux avant de rouler.**

Voir plus de produits R&G pour votre moto via ce lien :

[R&G Racing | All Products for KTM - 200 Duke \(rg-racing.com\)](http://www.rg-racing.com)

ISSUE 1 26/10/2022 (MH)

R&G

Unit 1, Shelley's Lane, East Worldham, Alton, Hampshire, GU34 3AQ

Tel: +44 (0)1420 89007 Fax: +44 (0)1420 87301 www.rg-racing.com Email: info@rg-racing.com



CONSUMER NOTICE

The catalogue description and any exhibition of samples are only broad indications of the Products and R&G may make design changes which do not diminish their performance or visual appeal and supplying them in such state shall conform to the order. The Buyer acknowledges no representation or warranty (other than as to title) has been given or will apply to the Products other than those in R&G's order or confirmation and the Buyer confirms it has chosen the Products as being of merchantable quality and suitable for its particular purposes. Where R&G fits the Products or undertakes other services it shall exercise reasonable skill and care and rectify any fault free of charge unless the workmanship has been disturbed. The Buyer is responsible for ensuring that the warranty on the motorcycle is not affected by the fitting of the Products. On return of any defective Products R&G shall at its option either supply a replacement or refund the purchase money but shall not be liable if the Products have been modified or used or maintained otherwise than in accordance with R&G's or manufacturer's instructions and good engineering practice or if the defect arises from accident or neglect. Other than identified above and subject to R&G not limiting its liability for causing death and personal injury, it shall not be liable for indirect or consequential loss and otherwise its liability shall be limited to the amounts paid by the Buyer for the Products or the fitting or service concerned. These terms do not affect the Buyer's statutory rights.

R&G RETURNS POLICY (NON-FAULTY GOODS)

Returns must be pre-authorized (if not pre-authorized the return will be rejected). Goods may only be returned direct to us if they were purchased direct from us (customer must prove if necessary). Otherwise to be returned to original vendor. Goods must be in re-sellable condition, in the opinion of R&G. All returns are subject to a 25% restocking and handling fee (25% of the gross value exc. P&P – at the prevailing price at time of purchase). The customer must pay any and all carriage charges. No returns of discontinued products, unless within 14 days of purchase. This policy does not affect your statutory rights and does not refer to faulty goods.

R&G

Unit 1, Shelley's Lane, East Worldham, Alton, Hampshire, GU34 3AQ

Tel: +44 (0)1420 89007 Fax: +44 (0)1420 87301 www.rg-racing.com Email: info@rg-racing.com