



**FITTING INSTRUCTIONS FOR LP0209BK LICENCE PLATE BRACKET**  
**KAWASAKI Z125 '16-**



**THIS KIT CONTAINS THE ITEMS PICTURED AND LABELLED BELOW.**  
**DO NOT PROCEED UNTIL YOU ARE SURE ALL PARTS ARE PRESENT.**

Please note that the way the kit is packed does not necessarily represent the way of mounting to the bike.

THE PARTS SHOWN MAY BE REPRESENTATIVE ONLY (FOR CLARITY OF INSTRUCTIONS ONLY).

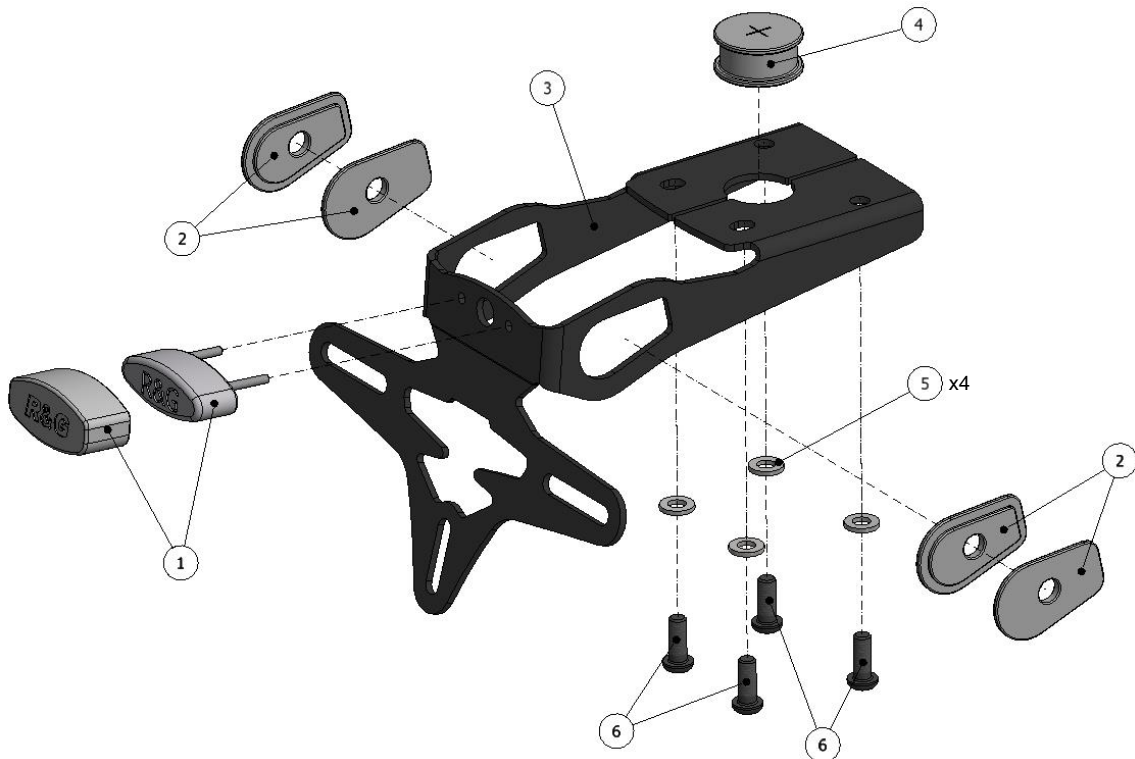

R&G Racing

Unit 1, Shelley's Lane, East Worldham, Alton, Hampshire, GU34 3AQ

Tel: +44 (0)1420 89007 Fax: +44 (0)1420 87301 [www.rg-racing.com](http://www.rg-racing.com) Email: [info@rg-racing.com](mailto:info@rg-racing.com)

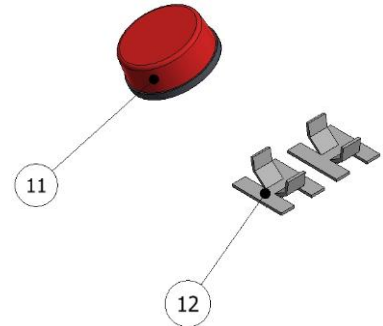
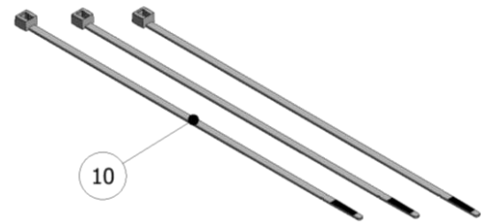
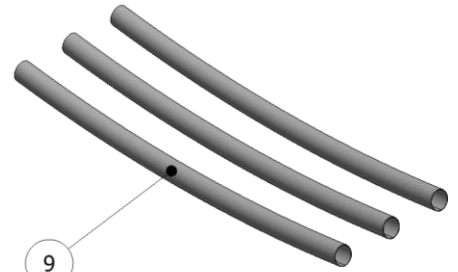
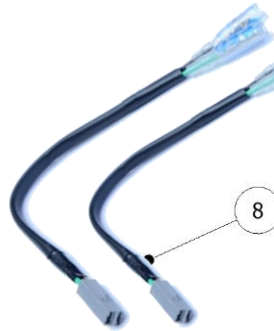

**LEGEND**

- ITEM 1 = LICENCE PLATE ILLUMINATOR & SHROUD (LA0002) (x1).
- ITEM 2 = INDICATOR ADAPTORS (I0026) (x4).
- ITEM 3 = LICENCE PLATE BRACKET (TB0209) (x1).
- ITEM 4 = RUBBER BUNG (RB0002) (x1).
- ITEM 5 = M6 WASHERS (x4).
- ITEM 6 = M6 x 16mm LONG BUTTON HEAD BOLTS (x4).
- ITEM 7 = LICENCE PLATE ILLUMINATOR CONNECTOR (CON0007) (x1).
- ITEM 8 = INDICATOR CONNECTOR (CON0032) (x2).
- ITEM 9 = 150mm LENGTH OF HEATSHRINK (x3).
- ITEM 10 = 2.5mm CABLE TIES (x3).
- ITEM 11 = REFLECTOR (x1).
- ITEM 12 = SELF-ADHESIVE CABLE CLIPS (x2).

Please note that in cases where kits are packed with rubber washers holding the components onto the bolt – *the rubber washers should be thrown away!*

**TOOLS REQUIRED**

- Set of metric Allen keys to include 4mm A/F size.
  - 6, 12 & 13mm spanners or sockets.
  - Philips screwdriver.
  - Cable cutters.

**MAXIMUM TORQUE SETTINGS**

- M4 Bolt = 8 Nm
- M5 Bolt = 12 Nm
- M6 Bolt = 15 Nm
- M8 Bolt = 20 Nm

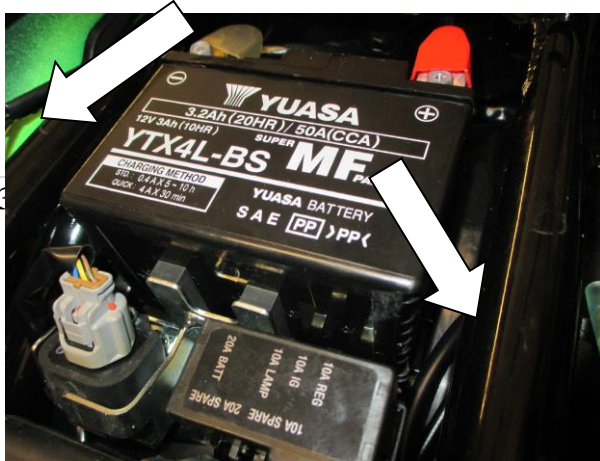

Picture 1

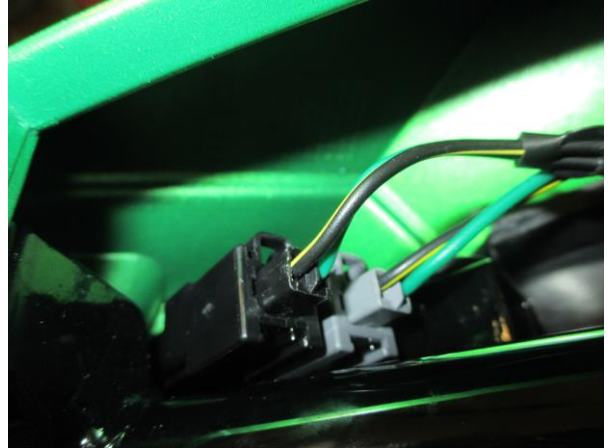

Picture 2



Picture 3

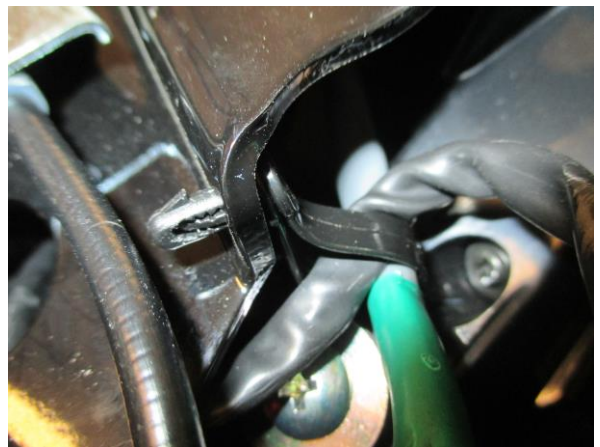

Picture 4



Picture 5



Picture 6





Picture 7



Picture 8



Picture 9



Picture 10



Picture 11



Picture 12





Picture 13



Picture 14



Picture 15



Picture 16



Picture 17



Picture 18



Picture 19



Picture 20

### **FITTING INSTRUCTIONS**

- To fit the R&G tail tidy, remove the seat using the key and locate the three licence plate illuminator/indicator connectors in the positions that are arrowed in picture 1.
- Disconnect the two indicator connectors, as shown in picture 2 and the licence plate illuminator connector that is shown in picture 3.
- Follow the licence plate illuminator wiring back to locate the plastic cable tidy and un-clip, as shown in picture 4, before feeding the wiring out of the rear subframe.
- Remove the four bolts that mount the OEM licence plate bracket to the underside of the bike, as shown in pictures 5 & 6 and gently remove from the bike, feeding the wiring out in the process.
- Take the licence plate bracket (item 3 – TB0209) and fit the R&G tail light (item 1 – LA0002) to the bracket, as shown in pictures 7 & 8. Fit one length of heatshrink to the wires, tighten the nuts on the rear and use a small amount of super glue to secure the light shroud in place.

### ***If fitting Mini Indicators***

- To fit the R&G Mini Indicators, fit one length of heatshrink to the wires of each indicator.
- Position two indicator adaptors (item 2 – I0026) onto the wiring of each indicator, ensuring the sides facing each other have the raised centre profile.
- Fit either indicator through the large slot on the side of the tail tidy, locating the indicator adaptors either side of the metal bracket, before fitting the nut onto the exposed thread and tightening, as shown in pictures 9 & 10.

### ***If fitting OEM Indicators***

- To remove the OEM indicators, remove the Phillips screw from the rear of the indicator mount and this will allow the mounting plate to come off, as shown in pictures 11 & 12.
- Remove the other metal plate that sits within the indicator rubber mount, and feed this off of the wiring. The indicator can now be twisted so that the rubber mount detaches from the plastic and can be removed from the OEM licence plate hanger, as shown in pictures 13 & 14.
- To fit the OEM indicators to the R&G Tail Tidy, re-fit the indicator and mounting rubber in the same way that it was removed to the indicator mounting hole on the main bracket, as shown in picture 15.
- Re-fit the metal plate into the rubber, along with the outer metal plate and Phillips screw as originally removed & shown in picture 16.





- Take the tail tidy assembly and offer up to the underside of the bike, fitting the four M6 x 16mm long button head bolts (item 6) and four M6 washers (item 5) through the four mounting holes on the tail tidy bracket and into the threaded bosses inside the tail unit, as shown in picture 17.
- Take the rubber bung (item 4 – RB0002) and locate through the large central hole on the tail tidy bracket and up inside the rectangular cutout on the plastic undertray, ensuring the rubber bung sits snugly with the recess of the bung on the underside, as shown in picture 18.
- Feed all three wires through the rubber bung and into the tail section of the bike, as shown in picture 19. *Use the cable ties or self-adhesive cable clips supplied to neaten the routing of the wiring if necessary.*
- Connect the licence plate illuminator to the connector supplied (item 7 – CON0007), ensuring the bullet connectors connect black to red and red to black, before fitting the remaining end of the wiring to the OEM connector already on the bike, as shown in picture 20.
- If re-fitting the OEM indicators, re-connect the original wiring connectors to those on the main loom.
- If fitting Mini Indicators, use the remaining two connector wires supplied (item 8 – CON0032) to connect the mini indicators to the main loom as below.
- If fitting R&G Aero Indicators the yellow wire on the Aero Indicators connects with the grey or green wire on the OEM indicator wiring and the black wire on the Mini Indicators connects with the yellow/black wire on the OEM indicator wiring. 1x set of RGR0001 resistors (available separately) are required to achieve the correct flash rate.
- If fitting R&G Mini Indicators with bulbs, the black/white wire on the Mini Indicators connects with the green or grey wire on the OEM indicator wiring and the black wire on the Mini Indicators connects with the black/yellow wire on the OEM indicator wiring.
- If fitting R&G Mini Indicators with LED's, the black/white wire on the Mini Indicators connects with the green or grey wire on the OEM indicator wiring and the black wire on the Mini Indicators connects with the black/yellow wire on the OEM indicator wiring. 1x set of RGR0001 resistors (available separately) are required to achieve the correct flash rate.
- If illumination fails on any light, re-connect the bullet connectors the other way around.
- Check for the correct operation of all lights.
- Re-fit the wiring clip and neatly route the wiring with the tail unit.
- Ensure the tail tidy is securely mounted and all bolts are fully tightened.
- Re-fit the seat.
- Re-fit the licence plate (it may require drilling).
- Depending on local laws, attach enclosed reflector in an appropriate location.
- Test the licence plate illuminator and all lights before riding.

ISSUE 1 15/09/2016 (AR)

**Digital copies of these instructions are available to download from [www.rg-racing.com](http://www.rg-racing.com)**

#### CONSUMER NOTICE

The catalogue description and any exhibition of samples are only broad indications of the Products and R&G may make design changes which do not diminish their performance or visual appeal and supplying them in such state shall conform to the order. The Buyer acknowledges no representation or warranty (other than as to title) has been given or will apply to the Products other than those in R&G's order or confirmation and the Buyer confirms it has chosen the Products as being of merchantable quality and suitable for its particular purposes. Where R&G fits the Products or undertakes other services it shall exercise reasonable skill and care and rectify any fault free of charge unless the workmanship has been disturbed. The Buyer is responsible for ensuring that the warranty on the motorcycle is not affected by the fitting of the Products. On return of any defective Products R&G shall at its option either supply a replacement or refund the purchase money but shall not be liable if the Products have been modified or used or maintained otherwise than in accordance with R&G's or manufacturer's instructions and good engineering practice or if the defect arises from accident or neglect. Other than identified above and subject to R&G not limiting its liability for causing death and personal injury, it shall not be liable for indirect or consequential loss and otherwise its liability shall be limited to the amounts paid by the Buyer for the Products or the fitting or service concerned. These terms do not affect the Buyer's statutory rights.

R&G Racing

Unit 1, Shelley's Lane, East Worldham, Alton, Hampshire, GU34 3AQ

Tel: +44 (0)1420 89007 Fax: +44 (0)1420 87301 [www.rg-racing.com](http://www.rg-racing.com) Email: [info@rg-racing.com](mailto:info@rg-racing.com)



**R&G RACING RETURNS POLICY (NON-FAULTY GOODS)**

Returns must be pre-authorised (if not pre-authorised the return will be rejected). Goods may only be returned direct to us if they were purchased direct from us (customer must prove if necessary). Otherwise to be returned to original vendor. Goods must be in re-sellable condition, in the opinion of R&G Racing. All returns are subject to a 25% restocking and handling fee (25% of the gross value exc. P&P – at the prevailing price at time of purchase). The customer must pay any and all carriage charges. No returns of discontinued products, unless within 14 days of purchase. This policy does not affect your statutory rights and does not refer to faulty goods.





**NOTICE DE MONTAGE POUR LP0209BK SUPPORT DE PLAQUE  
KAWASAKI Z125 '16-**

Page | 9



**Le kit contient les articles exposés ci-dessous, vérifier que toutes les pièces soient présentes avant de procéder au montage.**

**LA FAÇON DONT LE KIT EST EMBALLE NE CORRESPOND PAS FORCEMENT A LA FAÇON DE MONTER LES PIÈCES SUR LA MOTO.**

**LES PARTIES PRESENTEES PEUVENT ETRE UNIQUEMENT REPRESENTATIVES (POUR LA CLARTE DES INSTRUCTIONS UNIQUEMENT).**

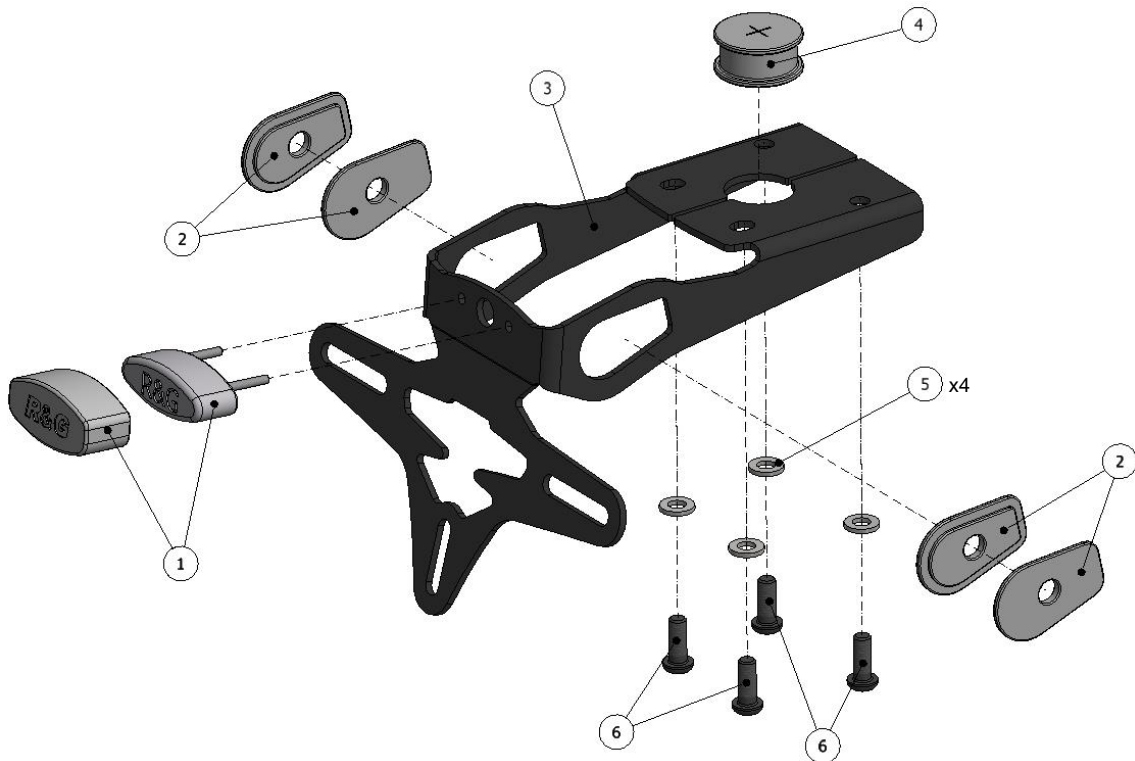

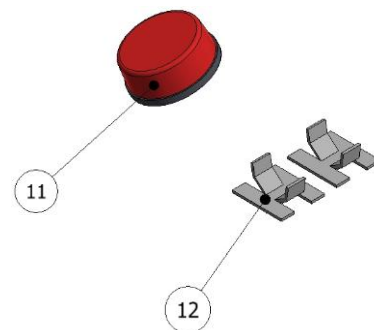
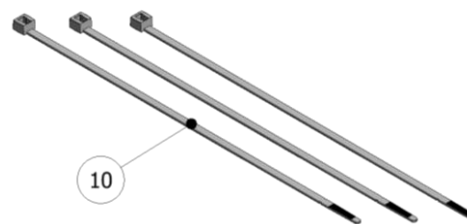
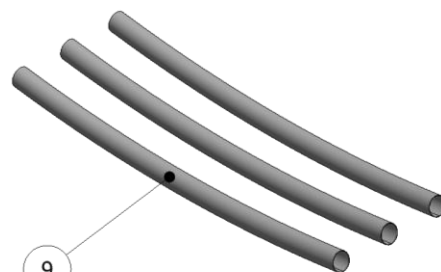

### **LEGENDE**

- ARTICLE 1 = FEU DE PLAQUE & LINCEUL (LA0002) (x1).  
 ARTICLE 2 = ADAPTATEURS CLIGNOTANTS (I0026) (x4).  
 ARTICLE 3 = SUPPORT DE PLAQUE (TB0209) (x1).  
 ARTICLE 4 = GARNITURE EN CAOUTCHOUC (RB0002) (x1).  
 ARTICLE 5 = M6 RONDELLES (x4).  
 ARTICLE 6 = M6 x 16mm BOULONS (x4).  
 ARTICLE 7 = CONNECTEUR DE FEU DE PLAQUE (CON0007) (x1).  
 ARTICLE 8 = CONNECTEUR DE CLIGNOTANT (CON0032) (x2).  
 ARTICLE 9 = 150mm BANDEAU THERMO RETRACTABLE (x3).  
 ARTICLE 10 = 2.5mm COLLIERS DE SERRAGE (x3).  
 ARTICLE 11 = REFLECTEUR (x1).  
 ARTICLE 12 = CLIPS CÂBLE AUTOCOLLANTS (x2).

Notez que si les kits sont emballés avec des rondelles en caoutchouc servant à tenir les composants, *ces rondelles doivent être jetées!*

### **OUTILS REQUIS**

- Clés Allen 4mm.
- Clé à pipe 6, 12 & 13mm.
- Tournevis cruciforme.
- Pince coupante.

### **Couples de serrage recommandés :**

M4 BOULON = 8Nm  
 M5 BOULON = 12Nm  
 M6 BOULON = 15Nm  
 M8 BOULON = 20Nm

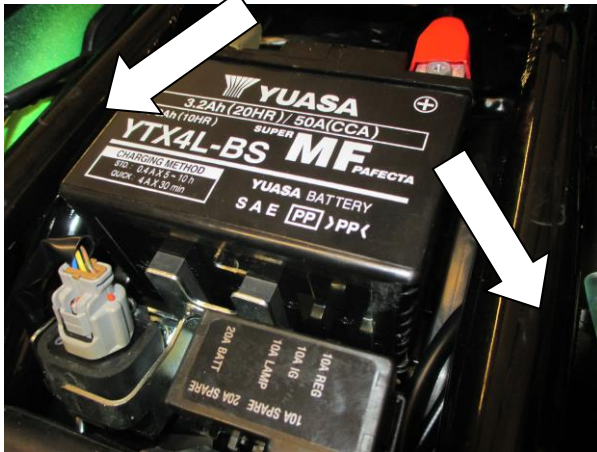

Article 1

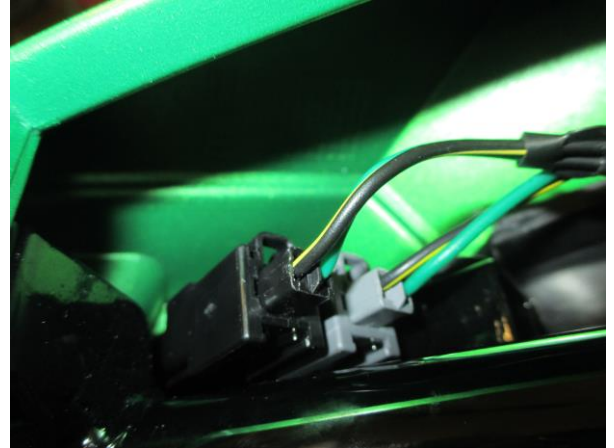

Article 2

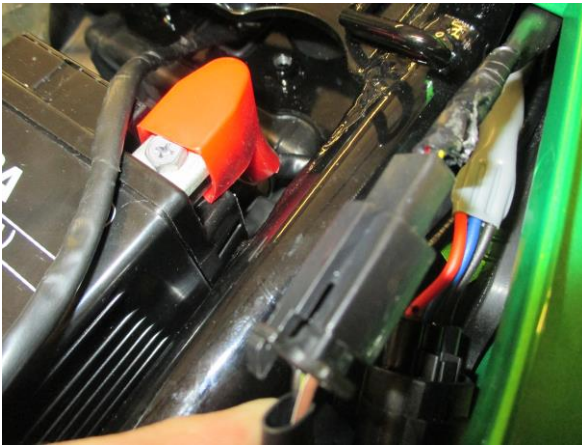

Article 3



Article 4



Article 5



Article 6





Article 7



Article 8



Article 9



Article 10



Article 11



Article 12





Article 13



Article 14



Article 15



Article 16



Article 17



Article 18



Article 19



Article 20

### **NOTICE DE MONTAGE**

- Pour monter le support de plaque R&G, enlever le siège à l'aide de la clé puis placer les 3 connecteurs de feu de plaque dans les positions indiquées sur la photo 1.
- Déconnecter les 2 connecteurs de clignotant, voir photo 2 et le connecteur de feu de plaque, voir photo 3.
- Suivez le retour de câbles de feu de plaque d'immatriculation pour placer le collier de serrage puis déclipser, voir photo 4, avant de passer les câbles à travers le sous cadre arrière.
- Enlever les 4 boulons qui fixent le support de plaque d'origine au dessous de la moto, voir photos 5 & 6 et enlevez le de la moto, en passant les fils au travers lors du process.
- Prendre le support de plaque (article 3 – TB0209) puis monter le feu de plaque R&G (article 1 – LA0002) sur le support, voir photos 7 & 8. Appliquer un manchon thermo rétractable sur les fils, serrer les écrous à l'arrière puis utiliser un peu de superglue pour fixer le linceul de feu en place.

#### ***Si vous montez des minis clignotants***

- Pour monter les minis clignotants R&G, appliquer un manchon thermo rétractable sur les fils de chaque clignotant.
- Positionner 2 adaptateurs de clignotant (article 2 –I0026) sur les fils de chaque clignotant, en veillant à ce que les bords qui se font face, aient le profil central surélevé.
- Monter chaque clignotant dans la fente large du côté du support de plaque, en plaçant les adaptateurs de clignotant de chaque côté du support métallique, avant d'insérer un écrou sur l'extrémité du filetage puis serrer, voir articles 9 & 10.

#### ***Si vous montez les clignotants d'origine***

- Pour enlever les clignotants d'origine, enlever les vis à l'arrière du support de clignotants et cela permettra de démonter la plaque de fixation, voir articles 11 & 12.
- Enlever l'autre plaque métallique qui se place dans le support de clignotant en caoutchouc, puis libérez la des fils. Le clignotant peut à présent être tordu de façon à ce que le support en caoutchouc se détache du plastique et peut être enlevé du support de plaque d'origine, voir articles 13 & 14.
- Pour monter les clignotants d'origine sur le support de plaque R&G, remonter le clignotant et le support en caoutchouc de la même façon qu'il a été enlevé du trou de fixation du clignotant sur le support principal, voir article 15.





- Remonter la plaque métallique dans le caoutchouc, avec la plaque métallique la plus à l'extérieur et la vis comme à l'origine, comme indiqué sur l'article 16.
- Prendre l'assemblage de support de plaque et montez le au dessous de la moto, en insérant les 4 boulons M6 x 16mm (article 6) et 4 rondelles M6 (article 5) dans les 4 trous de fixation du support de plaque puis dans les trous filetés à l'intérieur de l'unité de support, voir article 17.
- Prendre la garniture de caoutchouc (article 4 – RB0002) et placez la dans le trou large central du support de plaque puis à l'intérieur de l'ouverture rectangulaire du passage de roue en plastique, en veillant à ce que la garniture en caoutchouc se place parfaitement dans le creux de la garniture de caoutchouc au dessous, voir article 18.
- Passer les 3 fils dans la garniture de caoutchouc et dans la section de support de plaque de la moto, voir article 19. *Utiliser les colliers de serrage ou clips câble autocollant fournis pour organiser les fils si nécessaire.*
- Connecter le feu de plaque au connecteur fourni (article 7 – CON0007), en veillant à ce que les connecteurs connectent le noir au rouge et le rouge au noir, avant d'installer l'extrémité restante du câble au connecteur d'origine déjà sur la moto, voir article 20.
- Si vous remontez les clignotants d'origine, reconnecter les connecteurs d'origine à ceux du faisceau principal.
- Si vous montez les mini clignotants, utiliser les 2 fils de connecteurs fournis restants (article 8 – CON0032) sur les mini clignotants du faisceau principal, voir ci-dessous.
- Si vous remontez les clignotants R&G latéraux, le fil jaune sur les clignotants latéraux se connecte avec le fil gris ou vert sur le câblage de clignotant d'origine et le fil noir sur les minis clignotants se connecte avec le fil jaune/noir sur le câble de clignotant d'origine. 1x set de résistances RGR0001 (disponible séparément) sont requises pour obtenir le bon niveau d'éclairage.
- Si vous montez les mini clignotants R&G à ampoule, le fil noir/blanc sur les mini clignotants se connecte avec le fil vert ou gris sur le clignotant d'origine sur le câblage de clignotant d'origine et le fil noir sur les mini clignotants se connecte avec le fil noir/jaune sur le câblage de clignotant d'origine.
- Si vous montez les mini clignotants R&G à LED, le fil noir/blanc sur les mini clignotants se connecte avec le fil vert ou gris sur le câblage de clignotant d'origine et le fil noir sur les mini clignotants se connecte avec le fil noir/jaune sur le câblage de clignotant d'origine. 1x set de résistances RGR0001 (disponible séparément) sont requises pour obtenir le bon niveau d'éclairage.
- Si l'éclairage échoue, reconnecter les connecteurs de la façon inverse.
- **Vérifiez que les clignotants et les feux de plaque fonctionnent correctement.**
- Remonter le clip de fils et organiser les fils au sein de l'unité de support de plaque.
- Vérifier que le support de plaque soit correctement monté et que tous les boulons soient complètement serrés.
- Remonter le siège.
- Remontez la plaque d'immatriculation (Peut nécessiter un perçage).
- Selon les lois locales, attacher les réflecteurs aux endroits appropriés.
- Testez le feu de plaque d'immatriculation et tous les autres feux avant de prendre la route.

ISSUE 1 15/09/2016 (AR)

**Notice disponible sur [www.rg-racing.com](http://www.rg-racing.com)**

#### CONSUMER NOTICE

The catalogue description and any exhibition of samples are only broad indications of the Products and R&G may make design changes which do not diminish their performance or visual appeal and supplying them in such state shall conform to the order. The Buyer acknowledges no representation or warranty (other than as to title) has been given or will apply to the Products other than those in R&G's order or confirmation and the Buyer confirms it has chosen the Products as being of merchantable quality and suitable for its particular purposes. Where R&G fits the Products or undertakes other services it shall exercise reasonable skill and care and rectify any fault free of charge unless the workmanship has been disturbed. The Buyer is responsible for ensuring that the warranty on the motorcycle is not affected by the fitting of the Products. On return of any defective Products R&G shall at its option either supply a replacement or refund the purchase money but shall not be liable if the Products have been modified or used or maintained otherwise than in accordance with R&G's or manufacturer's instructions and good engineering practice or if the defect arises from accident

R&G Racing

Unit 1, Shelley's Lane, East Worldham, Alton, Hampshire, GU34 3AQ

Tel: +44 (0)1420 89007 Fax: +44 (0)1420 87301 [www.rg-racing.com](http://www.rg-racing.com) Email: [info@rg-racing.com](mailto:info@rg-racing.com)



or neglect. Other than identified above and subject to R&G not limiting its liability for causing death and personal injury, it shall not be liable for indirect or consequential loss and otherwise its liability shall be limited to the amounts paid by the Buyer for the Products or the fitting or service concerned. These terms do not affect the Buyer's statutory rights.

**R&G RACING RETURNS POLICY (NON-FAULTY GOODS)**

Returns must be pre-authorized (if not pre-authorized the return will be rejected). Goods may only be returned direct to us if they were purchased direct from us (customer must prove if necessary). Otherwise to be returned to original vendor. Goods must be in re-sellable condition, in the opinion of R&G Racing. All returns are subject to a 25% restocking and handling fee (25% of the gross value exc. P&P – at the prevailing price at time of purchase). The customer must pay any and all carriage charges. No returns of discontinued products, unless within 14 days of purchase. This policy does not affect your statutory rights and does not refer to faulty goods.